

### Punch Pin Blanks

Part Number	Drive Size	A inch/mm	B inch/mm	Minimum Pen inch/mm
5TXI-249B	5	.059/1.49	.043/1.09	.035/.89
6TXI-249B	6	.070/1.77	.050/1.29	.045/1.14
7TXI-249B	7	.082/2.09	.059/1.52	.050/1.27
8TXI-249B	8	.095/2.41	.069/1.75	.055/1.40
9TXI-249B	9	.102/2.59	.074/1.88	.060/1.52
10TXI-249B	10	.111/2.81	.081/2.05	.065/1.65
15TXI-249B	15	.132/3.35	.096/2.43	.075/1.91
20TXI-249B	20	.155/3.93	.112/2.85	.095/2.41
25TXI-249B	25	.178/4.53	.129/3.27	.120/3.05
27TXI-249B	27	.200/5.09	.144/3.67	.125/3.18
30TXI-249B	30	.221/5.62	.160/4.06	.130/3.30
40TXI-249B	40	.267/6.78	.192/4.89	.140/3.56
45TXI-249B	45	.313/7.95	.224/5.68	.160/4.06
50TXI-249B	50	.353/8.96	.256/6.50	.180/4.57
55TXI-249B	55	.447/11.35	.318/8.09	.220/5.59
60TXI-249B	60	.529/13.45	.381/9.68	.290/7.37

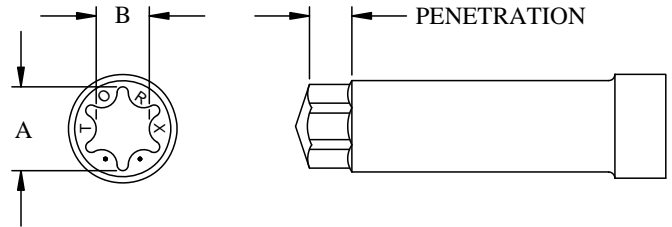

### Tamper Resistant Punch Pins

Part Number	Drive Size	A inch/mm	B inch/mm	Penetration inch/mm
8TXI-257-HX	8	.095/2.41	.069/1.75	.035/.89
10TXI-251-HX	10	.111/2.81	.081/2.05	.040/1.02
15TXI-251-HX	15	.132/3.35	.096/2.43	.045/1.14
20TXI-253-HX	20	.155/3.93	.112/2.85	.050/1.27
25TXI-253-HX	25	.178/4.53	.129/3.27	.055/1.40
27TXI-251-HX	27	.200/5.09	.144/3.67	.065/1.65
30TXI-253-HX	30	.221/5.62	.160/4.06	.070/1.78
40TXI-254-HX	40	.267/6.78	.192/4.89	.097/2.46
45TXI-253-HX	45	.313/7.95	.224/5.68	.110/2.79
50TXI-251-HX	50	.353/8.96	.256/6.50	.110/2.79
55TXI-253-HX	55	.447/11.35	.318/8.09	.145/3.68
60TXI-254-HX	60	.529/13.44	.381/9.68	.185/4.70

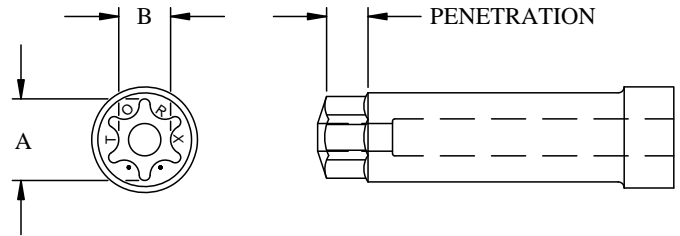

### Hexagon Washer Pin (One-Piece)

Part Number	Drive Size	A inch/mm	B inch/mm	Length inch/mm	Penetration inch/mm
8TXI-200	8	.095/2.41	.069/1.75	1.277/32.44	.036/.091
10TXI-200	10	.111/2.81	.081/2.05	1.277/32.44	.045/1.14
15TXI-200	15	.132/3.35	.096/2.43	1.277/32.44	.050/1.27
20TXI-200	20	.155/3.93	.112/2.85	1.277/32.44	.065/1.65
25TXI-200	25	.178/4.53	.129/3.27	1.277/32.44	.070/1.78
27TXI-200	27	.200/5.09	.144/3.67	1.277/32.44	.080/2.03
30TXI-200	30	.221/5.62	.160/4.06	1.559/39.59	.095/2.41
40TXI-200	40	.267/6.78	.192/4.89	1.559/39.59	.115/2.92
45TXI-200	45	.313/7.95	.224/5.68	1.559/39.59	.140/3.56

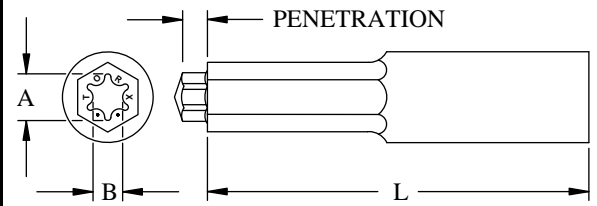

**1. Punch Pin materials:**

- M2 at RC 61-64
- M42 at RC 63-65

**2. Special penetrations available. Specify required penetration when ordering.**

**3. Oversize pins available for heavy or hot heading plating applications.**

**4. PVD Coatings available for cold & hot heading applications.**